

Overview

The Wireless Single Pushbutton Control is designed to be used with an existing Gate Access System. The Pushbutton Control allows user to exit through gate by pushing the button.

Carton Inventory

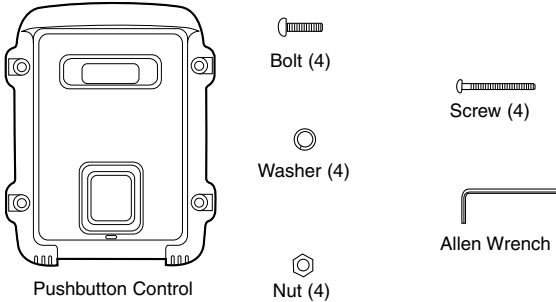

Assembly

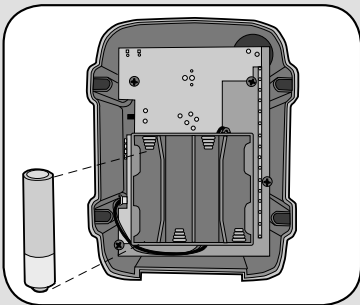

Install 4 AA Alkaline batteries (not provided). (Lithium batteries recommended for colder environments.) Keypad will beep.

Keypad will continuously beep indicating no Master PIN Number has been programmed. Proceed to Initial Setup.

Initial Setup

Keypad

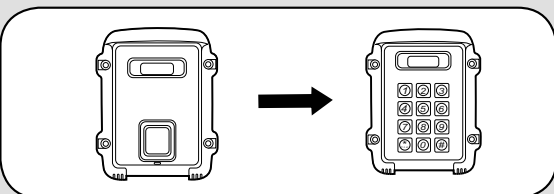

- Step 1:** Press the Learn button on the Pushbutton Control.
- Step 2:** Within 5 seconds, enter the Master PIN Number on the main Keypad.
- Step 3:** Press "05" on Keypad. Pushbutton Control will beep indicating programming is successful.

Pre-Installed Liftmaster Receiver

Step 1: Pry open the front panel of the receiver case with a coin or a screwdriver.

Step 2: Press and release the Learn button on the receiver. The Indicator Light will light for 30 seconds indicating that receiver is in Learn Mode.

Step 3: Within 30 seconds, press and hold the Learn button on the Intercom for 2 seconds.

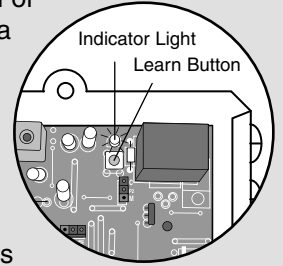

Repeat Steps 2-3 for each remote, or control device that will be used to access the Liftmaster door or gate operator.

Erase All Control Codes

Press and hold the Learn button on the receiver until the Indicator Light turns off indicating that the receiver memory is clear (about 6 seconds).

Mount Pushbutton Control

It is recommended that Pushbutton Control be mounted to a Gooseneck post or non-metallic surface.

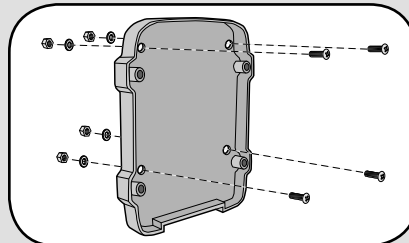

Step 1

Choose mounting location for Pushbutton Control. Remove the back panel and attach it to a solid surface or post.

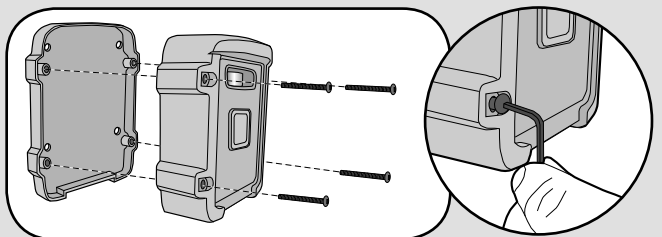

Step 2

Mount the Pushbutton Control onto the back panel with screws. Tighten screws with Allen wrench.

Operation

Push button on Pushbutton Control to exit.

Clear Memory: Press the Learn button until a beep is heard.

Warranty

The Chamberlain Group, Inc. ("Seller") warrants to the first purchaser of this product, for the structure in which this product is originally installed, that it is free from defect in materials and/or workmanship for a period of one year from the date of purchase.

The proper operation of this product is dependent on your compliance with the instructions regarding installation, operation, maintenance and testing. Failure to comply strictly with those instructions will void this limited warranty in its entirety.

If, during the limited warranty period, this product appears to contain a defect covered by this limited warranty, call 1-800-528-2806 before dismantling this product. Then send this product, pre-paid and insured, to our service center for warranty replacement. Products returned to Seller for warranty replacement, which upon receipt by Seller are confirmed to be defective and covered by this limited warranty, will be replaced (at Seller's sole option) at no cost to you and returned pre-paid. Defective parts will be replaced with new or factory-rebuilt parts at Seller's sole option.

THIS LIMITED WARRANTY IS IN LIEU OF ANY OTHER WARRANTIES, EXPRESS OR IMPLIED, INCLUDING ANY IMPLIED WARRANTY OF MERCHANTABILITY OR FITNESS FOR A PARTICULAR PURPOSE OR OTHERWISE, AND OF ANY OTHER OBLIGATIONS OR LIABILITY ON SELLER'S PART. THIS LIMITED WARRANTY DOES NOT COVER NON-DEFECT DAMAGE, DAMAGE CAUSED BY IMPROPER INSTALLATION, OPERATION OR CARE (INCLUDING, BUT NOT LIMITED TO ABUSE, MISUSE, FAILURE TO PROVIDE REASONABLE AND NECESSARY MAINTENANCE, UNAUTHORIZED REPAIRS OR ANY ALTERATIONS TO THIS PRODUCT), LABOR CHARGES FOR REINSTALLING A REPAIRED OR REPLACED UNIT, PROBLEMS RELATED TO INTERFERENCE, OR REPLACEMENT OF BATTERIES.

UNDER NO CIRCUMSTANCES SHALL SELLER BE LIABLE FOR CONSEQUENTIAL, INCIDENTAL OR SPECIAL DAMAGES ARISING IN CONNECTION WITH USE, OR INABILITY TO USE, THIS PRODUCT. IN NO EVENT SHALL SELLER'S LIABILITY FOR BREACH OF WARRANTY, BREACH OF CONTRACT, NEGLIGENCE OR STRICT LIABILITY EXCEED THE COST OF THE PRODUCT COVERED HEREBY. NO PERSON IS AUTHORIZED TO ASSUME FOR US ANY OTHER LIABILITY IN CONNECTION WITH THE SALE OF THIS PRODUCT.

Some States do not allow the exclusion or limitation of consequential, incidental or special damages, so the above limitation or exclusion may not apply to you. This limited warranty gives you specific legal rights, and you may also have other rights which vary from state to state.